

2023

Z

rk ——— MPa
 ln ——— mm²
 t2 2.52 c c n 3-2
 ln ——— mm² 3-2
 ——— C50 1.0
 C80 0.8
 ——— 3.0
 c ——— N/mm²

ZL200910061143.2 ZL201610768558.3 ZL201210013314.6
 ZL201410446440.X ZL201410446446.7 ZL201510870416.3 ZL02138777.X 5
 6 7 8 9 3 10

1
 2 35%
 3 5 1000kN 20 14.6m
 5 2000kN

2000kN 40m 40m 35m 30m 800kN 600kN 600kN
 2

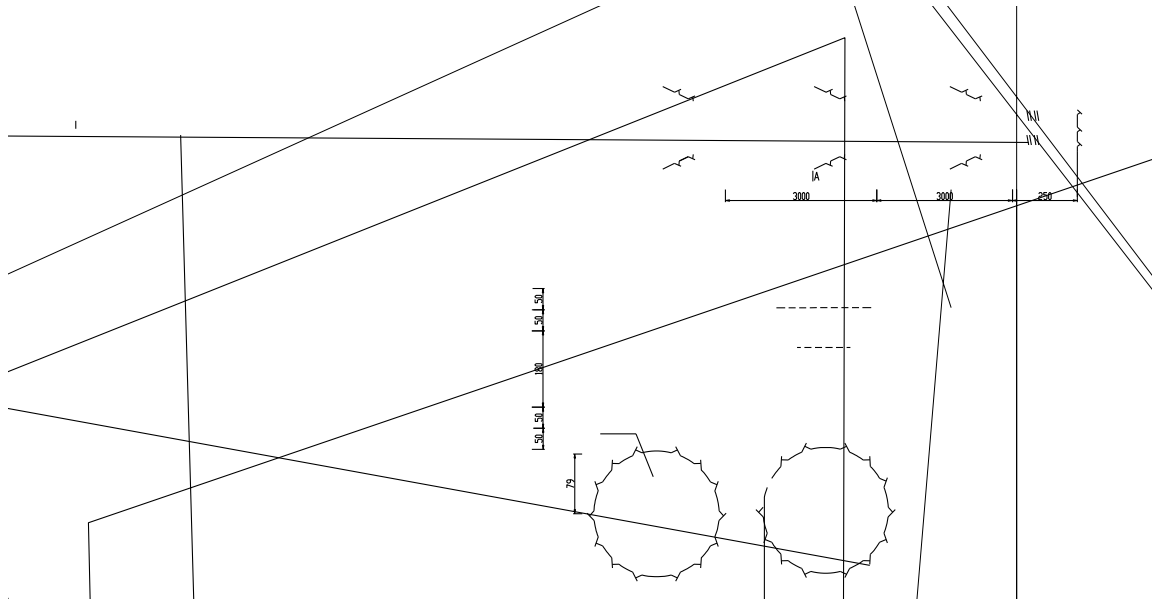

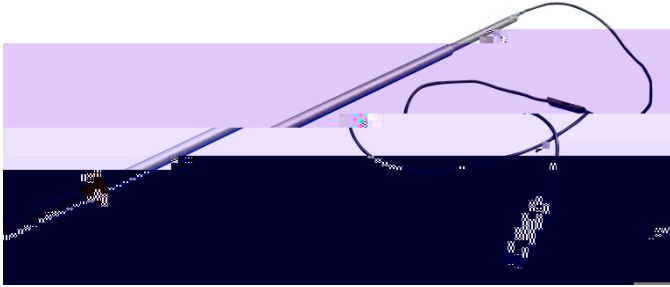
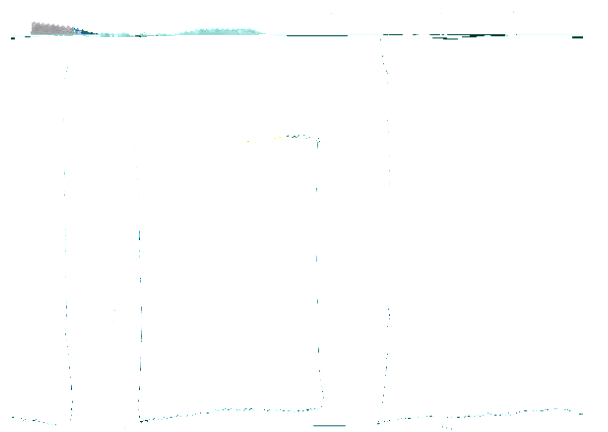
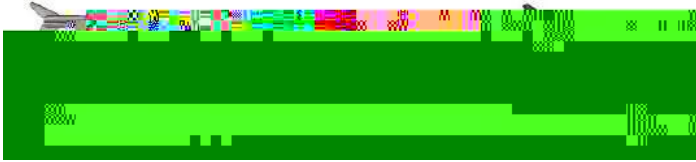
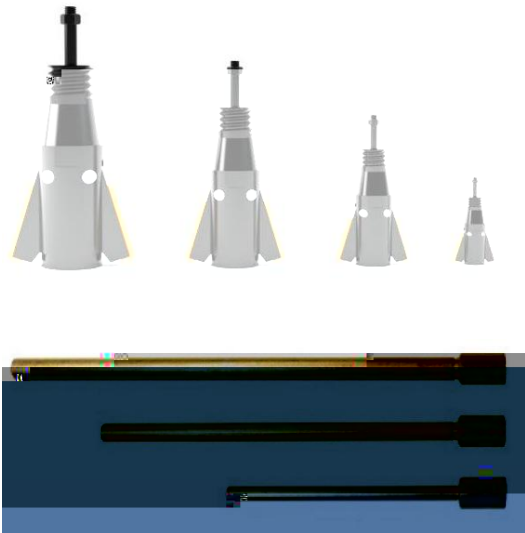

3

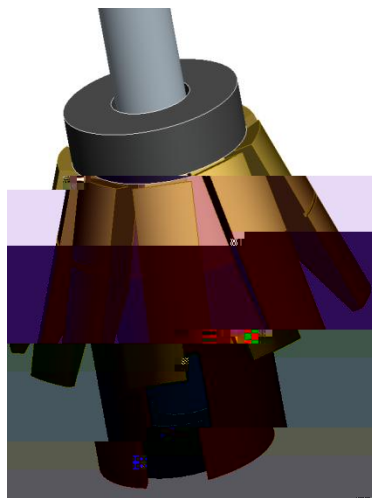
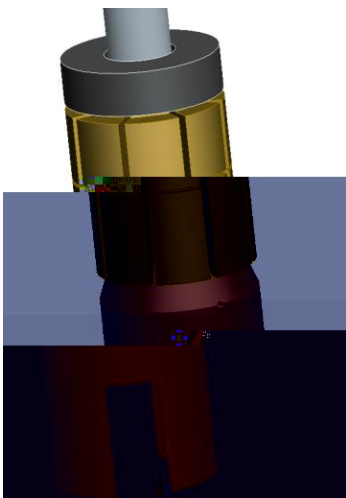

4

5

30

T/CECS 813-2021

30

5

400

2

100

1.6

1.4

1

3				/	2014.10	/	/
4				0731-851 70677	2015.11	719.24	/
5				027-6527 6668	2016.7	630.75	/
6				15987111 637	2018.1	294.318	/
7				027-6527 6668	2019.9	1056.76	/
8				022-5809 6860	2020.11	308.26	/
9				1588978 0001	2021.2	818.28	/
10				027-6527 6668	2021.5	553.83	/

/

--	--

